

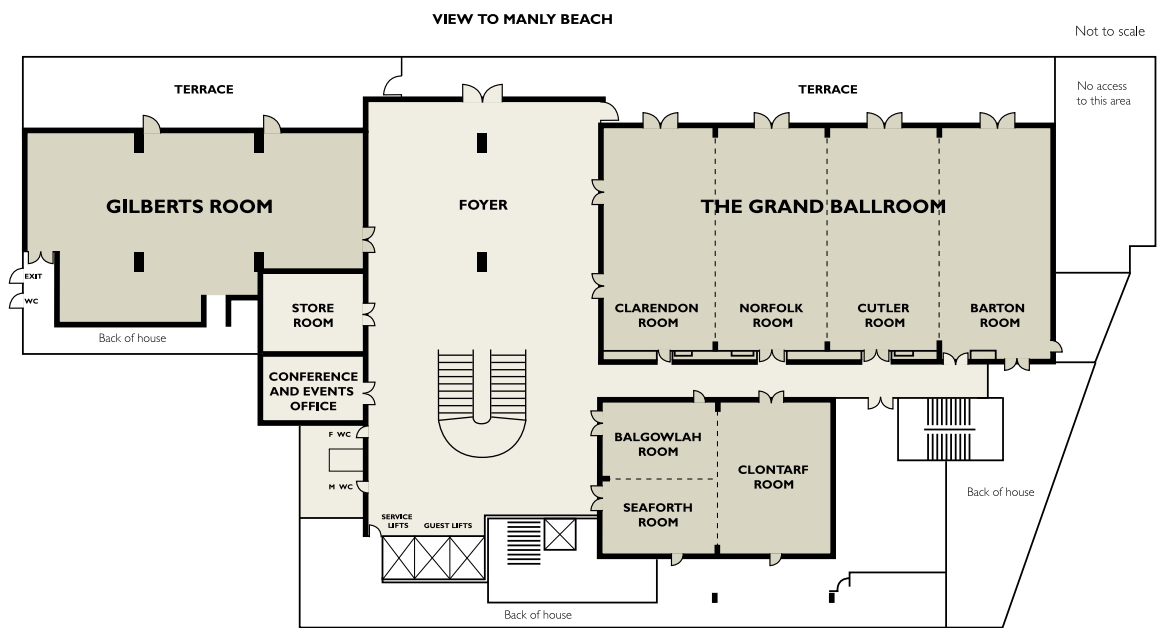

2

Floor Plans

Level 1 – Conference Floor



Level 3 – Pacific Room





2

Conference Room Capacities

| Room Name | Metres | Area (m ²) | U-Shape | Class-room | Cabaret | Theatre | Cocktail | Banquet | |
|---------------------------------|--------------------|------------------------|---------|------------|---------|---------|----------|---------|-----|
| Clarendon | 1/4 Grand Ballroom | 8x16x3.4 | 128 | 30 | 55 | 54 | 120 | 100 | 70 |
| Norfolk | | 8x16x3.4 | 128 | 30 | 55 | 54 | 120 | 100 | 70 |
| Culter | | 8x16x3.4 | 128 | 30 | 55 | 54 | 120 | 100 | 70 |
| Barton | | 8x16x3.4 | 128 | 30 | 55 | 54 | 120 | 100 | 70 |
| Clarendon / Norfolk | 1/2 Grand Ballroom | 16x16x3.4 | 256 | 50 | 135 | 135 | 250 | 220 | 140 |
| Clarendon / Norfolk / Cutler | 3/4 Grand Ballroom | 24x16x3.4 | 384 | - | 190 | 160 | 380 | 350 | 250 |
| Grand Ballroom | | 32x16x3.4 | 512 | - | 250 | 288 | 550 | 500 | 420 |
| Ballroom Terrace | | 4.5x43x4 | 194 | - | - | - | - | 200 | 140 |
| Balgowlah | | 8x5x3 | 40 | 12 | 18 | 18 | 45 | 30 | 20 |
| Seaforth | | 8x5x3 | 40 | 12 | 18 | 18 | 45 | 30 | 20 |
| Clontarf | | 8x10x3 | 80 | 24 | 40 | 36 | 75 | 50 | 40 |
| Balgowlah / Seaforth | | 8x10x3 | 80 | 24 | 40 | 36 | 75 | 50 | 40 |
| Balgowlah / Seaforth / Clontarf | | 16x10x3 | 160 | 50 | 75 | 90 | 140 | 120 | 90 |
| Banquet Foyer | | 16x16x3.4 | 256 | - | - | - | - | 300 | - |
| Gilberts Room | | 8x20x3.4 | 160 | 40 | 90 | 100 | 170 | 250 | 180 |
| Gilberts Terrace | | 4.5x21.5x4 | 95 | - | - | - | - | 100 | 95 |
| Pacific Room | | 9.5x5.5x2.4 | 44 | 18 | 20 | - | 40 | 40 | - |