

FLOOR PLANS

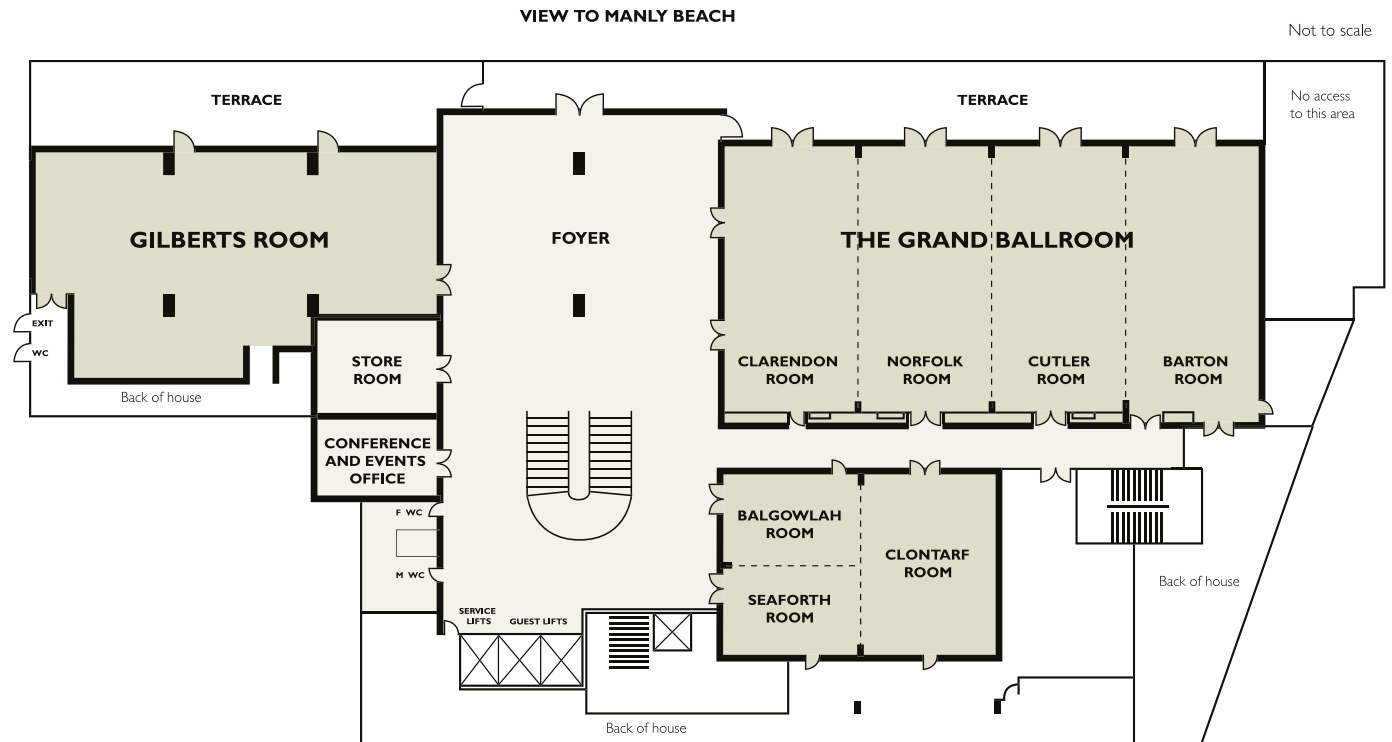

With a series of inspiring elements from the pre-function area to the meeting room your guests will have an opportunity to pause and reflect on what creates balance in a fast-paced, demanding world. From this initial arrival experience each guest will feel more inspired to personally engage and contribute to the meeting agenda.



CAPACITY



CONFERENCE ROOM CAPACITIES

| Room Name | Meters | Area(m ²) | U-Shape | Classroom | Cabaret | Theatre | Cocktail | Banquet |
|---|----------------|-----------------------|---------|-----------|---------|---------|----------|---------|
| Clarendon - 1/4 Grand Ballroom | 8 x 16 x 3.4 | 128 | 30 | 42 | 48 | 100 | 100 | 60 |
| Norfolk - 1/4 Grand Ballroom | 8 x 16 x 3.4 | 128 | 36 | 54 | 48 | 120 | 100 | 60 |
| Cutler - 1/4 Grand Ballroom | 8 x 16 x 3.4 | 128 | 36 | 54 | 48 | 120 | 100 | 60 |
| Barton - 1/4 Grand Ballroom | 8 x 16 x 3.4 | 128 | 36 | 54 | 48 | 120 | 100 | 60 |
| Clarendon / Norfolk - 1/2 Grand Ballroom | 16 x 16 x 3.4 | 256 | 48 | 100 | 120 | 230 | 220 | 140 |
| Clarendon / Norfolk / Cutler - 3/4 Grand Ballroom | 24 x 16 x 3.4 | 384 | - | 160 | 168 | 360 | 360 | 240 |
| Grand Ballroom | 32 x 16 x 3.4 | 512 | - | 220 | 240 | 500 | 500 | 350 |
| Ballroom Terrace | 4.5 x 43 x 4 | 194 | - | - | 80 | - | 200 | 100 |
| Balgowlah | 8 x 5 x 3 | 40 | 12 | 18 | 16 | 30 | 30 | 20 |
| Seaforth | 8 x 5 x 3 | 40 | 12 | 18 | 16 | 30 | 30 | 20 |
| Clontarf | 8 x 10 x 3 | 80 | 24 | 36 | 32 | 70 | 50 | 40 |
| Balgowlah / Seaforth | 8 x 10 x 3 | 80 | 27 | 32 | 40 | 80 | 50 | 50 |
| Balgowlah / Seaforth / Clontarf (The Meeting Room) | 16 x 10 x 3 | 160 | 48 | 72 | 72 | 120 | 100 | 90 |
| Banquet Foyer | 16 x 16 x 3.4 | 256 | - | - | - | - | 300 | - |
| Gilberts Room | 8 x 16 x 3.4 | 160 | 42 | 81 | 88 | 160 | 220 | 150 |
| Gilberts Terrace | 4.5 x 21.5 x 4 | 95 | - | - | - | - | 100 | 80 |
| The Pacific Room By Sally Fitzgibbons | 9.5 x 5 x 2.4 | 44 | 18 | 20 | - | 30 | 40 | - |